

# ICP20/ICP25/ICP30 – Rotary self priming road tanker pumps

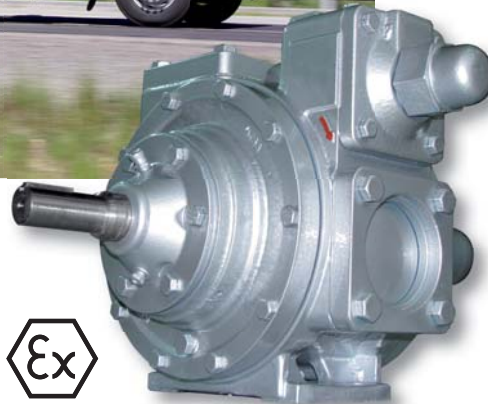

With their vast experience and success as an innovative leader in the dry bulk road transport market, GHH RAND now expand into the liquid tanker market offering a proven rotary vane pump for pumping products such as fertilizers, chemicals, solvents, soaps, paints, etc.

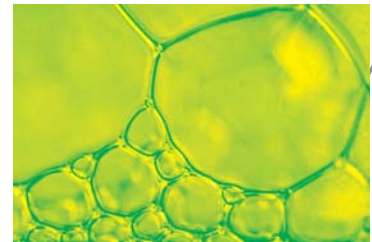

## Highlights

- Viscous and also volatile liquids to be pumped efficiently with low power requirements in comparison to similar type pumps.
- High flow rates at lower input speeds than other designed pumps.
- Lightweight to increase payload yet durable to withstand arduous road tanker environments.
- Low noise operation due to special vane design.
- FKM seal as a standard.
- Port size, thread & orientation options to suit your specific applications.
- Self adjusting vanes compensate for wear and extend the life of the pump.

# ICP20/ICP25/ICP30 – Cargo pumps for conveying of liquid material

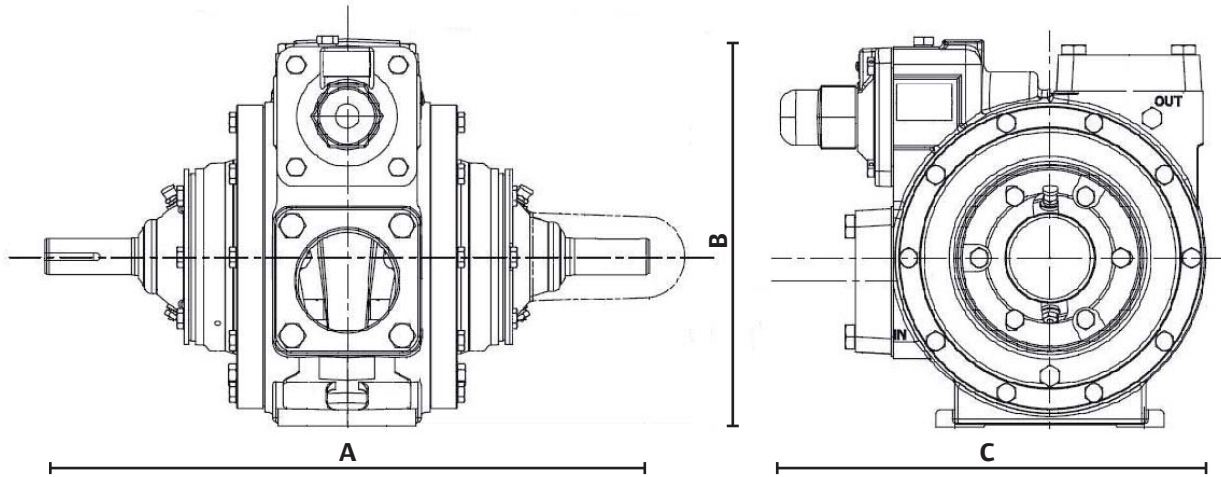

## Performance data (@ 30 SSU, diff. pressure 50.8 psi)

Model	ICP20		ICP25		ICP30	
rpm	520	640	520	640	520	640
gpm	50	63	92	112	205	259
hp	2.5	3.1	4.2	5.1	7.6	9.7
Weight	66 lbs		82 lbs		132 lbs	

## Dimensions (in)

Model	A	B	C
ICP20	16	9.17	10
ICP25	18.2	9.76	11.1
ICP30	19.2	12.32	13.58

## Maximum specifications

Model	Flow rate	Power consumption	Pump speed	Viscosity	Differential pressure	Working pressure	Temperature
	gpm	hp	rpm	SSU	psi	psi	°F
ICP20	88	7.8	780	20,000	125	197	300
ICP25	159	11.8	780	20,000	125	197	300
ICP30	271	13.9	640	20,000	125	197	300

## Your advantages

- Durable, long life bearing arrangement.
- Hollow rotor for reduced weight.
- Self-adjusting vanes compensate for wear, maintaining efficiency.
- Drain port for sample collection.
- Comprehensive range of drive methods including propshaft, hydraulic or electric motor, diesel engine.
- Regional support with our full & comprehensive well positioned partner network.

## Options

- Bypass spring range ratings.
- Different flange connections available.
- Air operated bypass valve for low/high volume flows.

## Accessories

- Inlet strainer basket with options of mesh rating to suit application.
- Adaptor and coupling for hydraulic drive.
- Hydraulic motor.
- Hydraulic control valve.

**GHH RAND/OEM Systems**  
**Ingersoll Rand Industrial Technologies**  
**800-B Beaty Street**  
**Davidson, NC 28036, USA**  
**Tel. 704 655 4715 • Fax 704 655 4725**  
**info\_ghh-rand@irco.com • www.ghhrand.com**

